

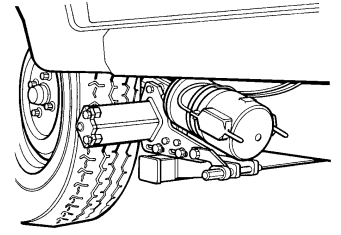

Caravan Mover Euro Mover

Version UK



Operating instructions Installation instructions

To be kept in the vehicle!

Page 2

Page 5

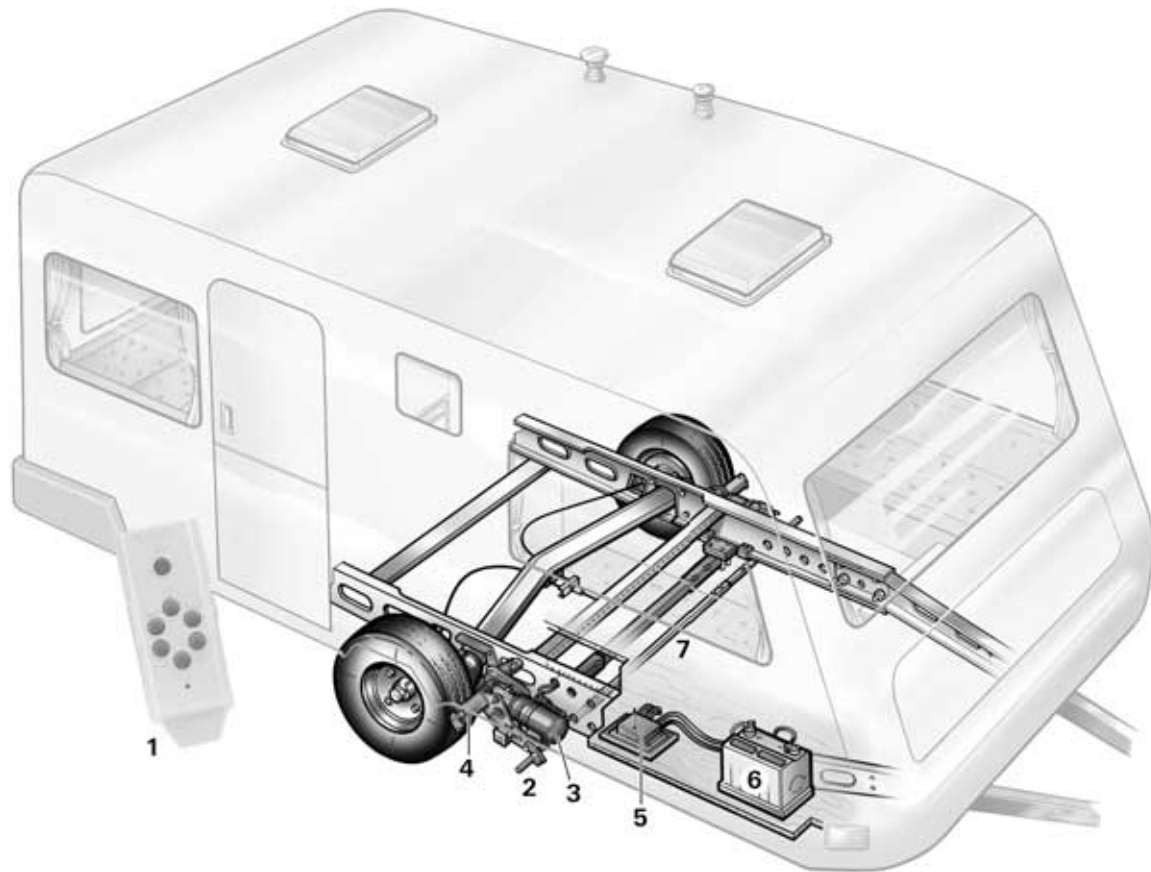

Installation example

- 1 Remote handset
- 2 Toggle crank
- 3 Drive motor
- 4 Drive roller
- 5 Electronic control unit
- 6 Battery
- 7 Cross actuation device
(Option)

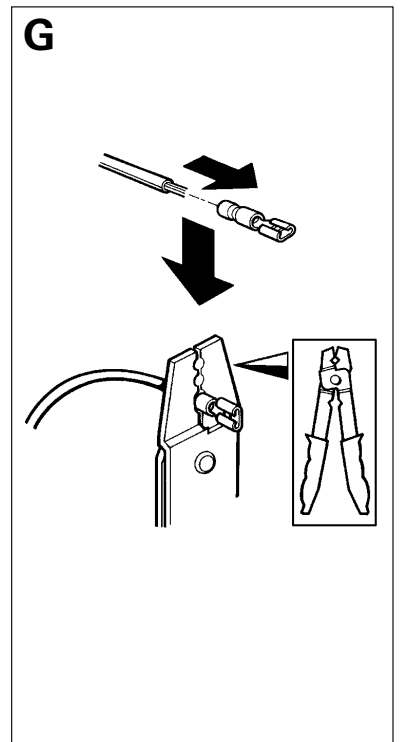
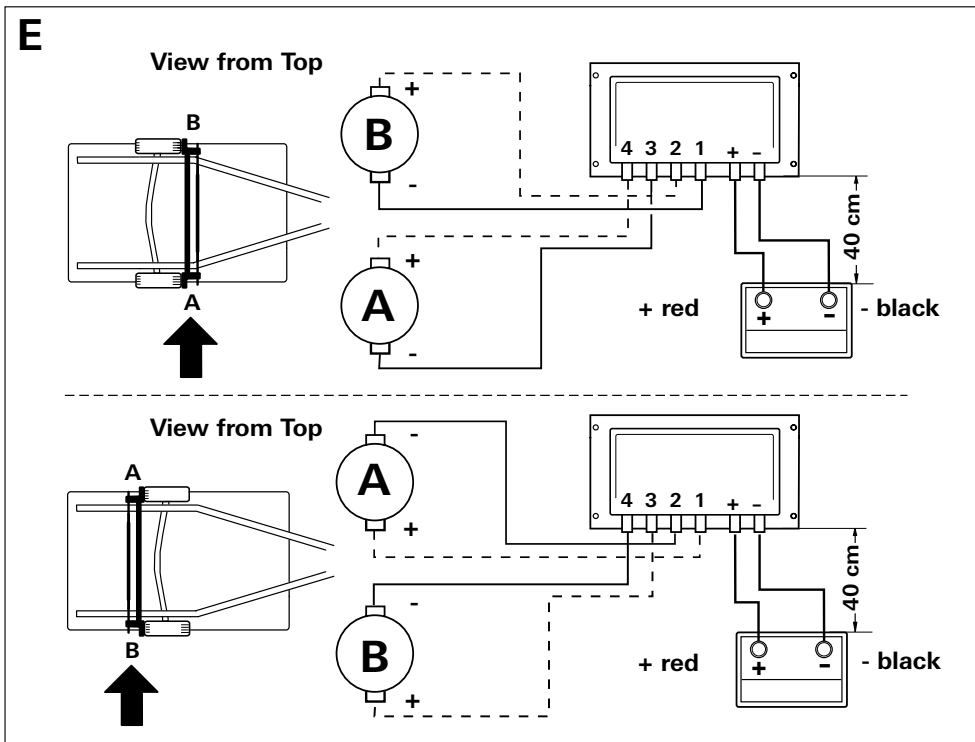
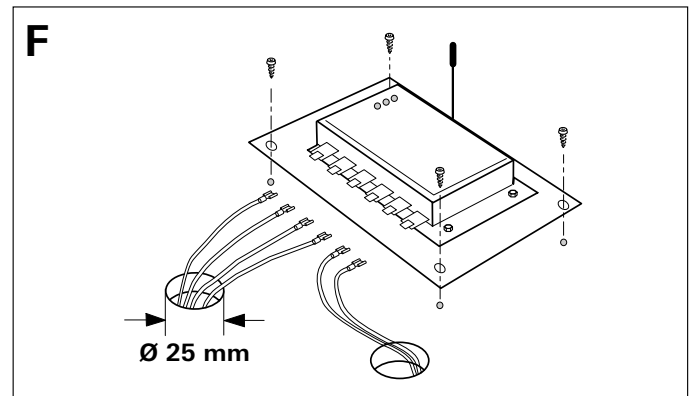
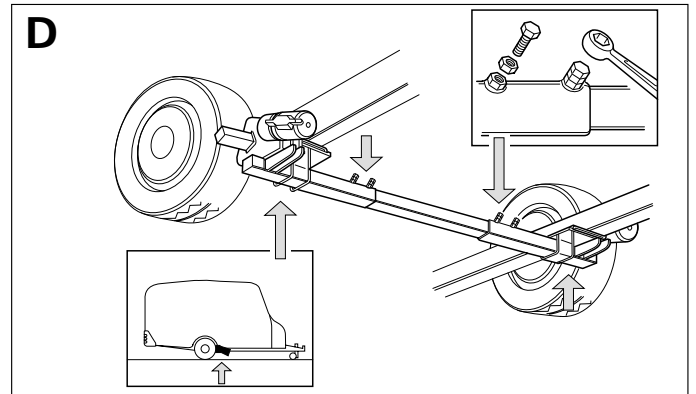
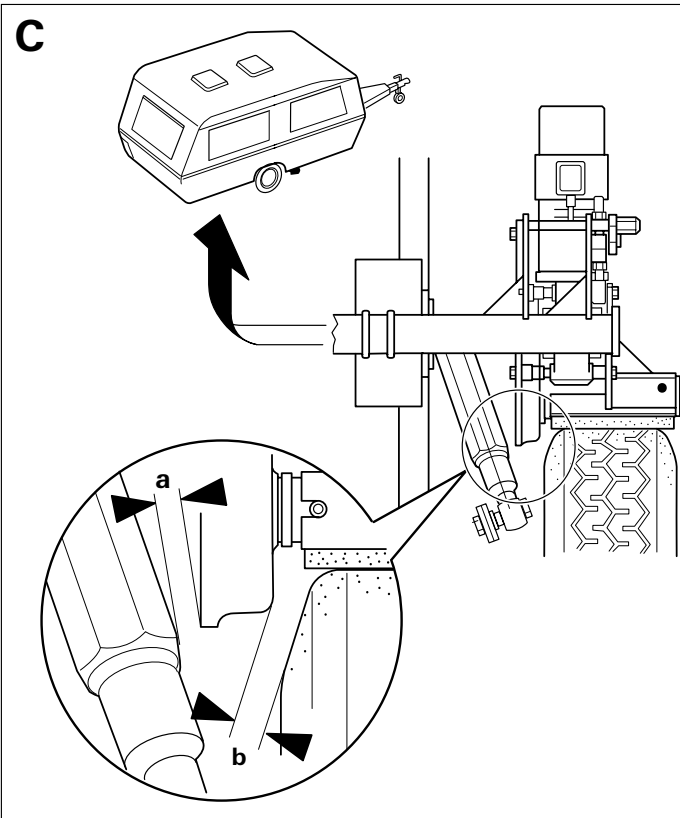
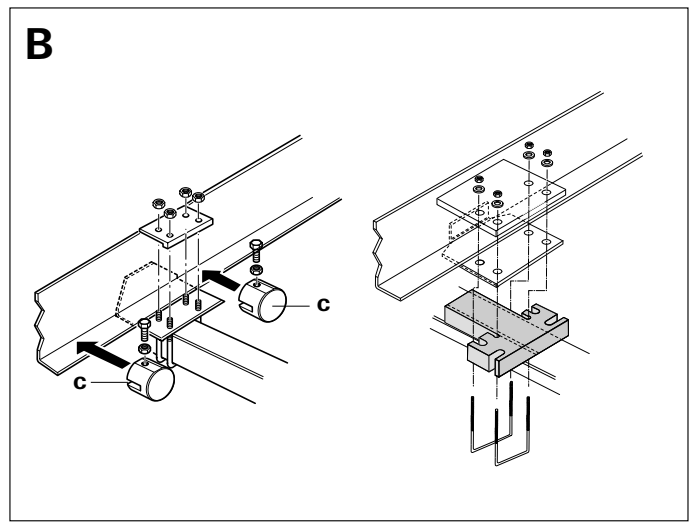
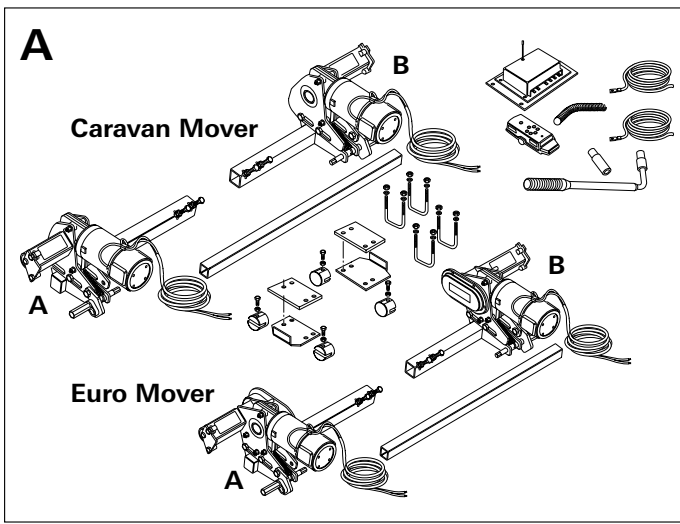

Operating instructions

Always observe the operating instructions and „Safety-related instructions“ prior to starting! The vehicle owner is responsible for correct operation of the appliance.

Function description

Note that only single axle caravans are suitable.

The Mover is a manoeuvring aid for moving a caravan without the assistance of a towing vehicle.

It consists of two separate drive units, each of which has a 12 Volt DC motor. These units are attached to the frame of the vehicle near the wheels and are connected by lateral bars.

Once the drive rollers have been engaged against the tyres using the provided wheel brace, the Mover is ready for operation. The equipment is operated using the remote control facility, which transmits radio signals to the relay controller. A separately-installed 12 Volt lead-acid battery (or suitable lead-gel battery) provides the relay controller with power.

 For an ease of operation, as an option, a cross actuation device is available (please ask your dealer).

Safety-related instructions

- Practice operating the Mover in an open area before using for the first time. **This to fully familiarise yourself with the handset/mover operation.**
- Always check tyres and drive rollers before using the equipment; remove sharp-edged stones and the like if necessary; replace used drive rollers.
- During operation, no persons are allowed inside the caravan.
- **All persons (particularly children)** must remain outside the Mover operating area.
- The distance between the radio remote control and the caravan **must not exceed 5 m** during manoeuvring!
- In the event of malfunctions pull on the handbrake.
- To prevent the caravan from tipping, direct the tow hitch downhill when manoeuvring down a slope.
- Always **first apply handbrake** after manoeuvring, **then remove drive rollers from tyres** and **block wheels** (particularly on sloping surfaces!). The Mover is **not suitable for use as a parking brake** for a parked caravan.
- Ensure that remote radio control is protected from unauthorised access (particularly by children!).
- Never tow caravan with the drive rollers engaged, since this can damage both the tyres and the towing vehicle.
- All wheels and tyres on the caravan must be of the same size and design (max. tyre width 205 mm, wider tyres can be severely damaged by the rollers).
- In order to ensure that the Mover operates correctly, the distance between the tyres and the released drive rollers must be 20 mm. All tyres must therefore have the same tyre pressure as per the manufacturer's instructions (check at regular intervals!). Readjustment is required if tyre wear has occurred or new tyres are fitted (see drive element installation point 4 and following text).
- Do **not** use the Mover as a support when jacking up the caravan, since this can damage the drive unit.

- Do not leave sensitive items such as cameras, personal stereo's ect close to the Mover control box or motor cables in the bedding locker's. The strong electromagnetic fields may cause them damage.
- The empty weight of the vehicle increases by the weight of the Movers, which reduces the payload of the vehicle.

Remote handset

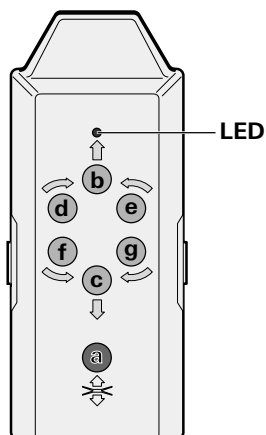

- a = on (press button twice within one second, LED illuminates)
- a = off (press button once)
- b = forward
- c = reverse
- d = left forwards
- e = right forwards
- f = left reverse
- g = right reverse

If no buttons are pressed for 40 seconds, the handset and therefore the Mover will turn itself off.

There is no on/off switch on the caravan to be operated.

Manoeuvring the caravan

 **Please read the „Safety-related instructions“ before using the Mover!**

1. With the caravan free from the tow vehicle (handbrake on), engage the drive rollers by use of the 19 mm AF wrench provided or the steady leg brace. The action will be quite stiff and will snap into place. The movement required is just over 1/2 turn. Turn the wrench until it will turn no more without excessive force. Perform at both sides of caravan.

 Before operating the Mover, release the handbrake.

2. Press the red button on the handset twice within one second. This will switch on the Mover controls.

3. The six direction buttons provide movement in six directions – forward, reverse, left forward, left reverse, right forward, right reverse. In addition, the „left forward“ and „right reverse“ buttons or „right forward“ and „left reverse“ buttons may be pressed at the same time to turn the caravan without moving forward.

4. The caravan will stop when the buttons are released or the radio signal is too weak. Other radio transmitters and other Carver Mover handsets will not cause operation of your Mover.

5. The Mover moves at a single speed only. The speed will increase a little when going downhill and decrease a little when going uphill.

6. Press the red button again to switch off the handset and Mover.

 **The red button may also be used as an emergency stop.**

7. After manoeuvring, **apply the handbrake first** and then **disengage the drive rollers from the tyres.**

Hitching to a tow car

1. It is totally possible to position the caravan's hitch to a stationary car tow ball using the Mover, but take some care.
2. Use the instructions above as your guide. Use the button controls to bring the caravan to the car (car handbrake „ON“, and car in gear). Use a button stabbing technique to exactly position the hitch directly over the ball. Lower the hitch to the ball and engage in the normal way using the jockey wheel.
3. Hitch the caravan in the normal way ready for towing. **You cannot tow the caravan with the Mover engaged!** Release drive elements from tyres using wheel spanner before starting off. Trying to drive away with the Mover still engaged, will damage your caravan tyres and strain your tow vehicle!

Maintenance

The drive units should be kept reasonably clean of road debris. Clean the area with a hose pipe to release mud, etc. along with cleaning the caravan. Make sure no large stones, wood branches, etc. are trapped in the mechanism. There is no more care than the above required on the drive units. The controllers require no maintenance. Keep the handset in a dry place.

It is extremely easy for you or your caravan dealer to perform the checking and maintenance of your Mover during the annual inspection of your caravan. If in doubt, please contact the Truma-Services (page 9).

1. Upon an annual basis (or before storing the caravan for the winter) we recommend that you clean the unit as described above, dry off and lightly spray the drive units and mechanisms with a silicon lubricant/water repellent. **Keep the spray off the rollers and tyres!** Apply and release the drive units a few times to work the spray into all the joints. Do not store the caravan with the drive rollers engaged.
2. To prevent the battery from becoming totally discharged during long periods of inactivity it must be disconnected and recharged before using again. Repeat section 1 before starting up and charge the caravan battery.

Checks

1. Always ask your dealer to check the installation each year when the caravan is serviced.
2. Check the installation, wiring and connections for damage at regular intervals. The drive units must be able to move freely and automatically move away from the tyres when released. If they do not, examine the unit for debris or corrosion at the pivot points and adjust if necessary. Free all pivots as required, oil or spray with WD40 to ensure full and correct movement.
3. After the annual inspection, check whether all motors react properly to the buttons on the remote control.

General instructions

The manufacturer is **not liable** for damage caused as a result of incorrect installation or operation.

The driver rollers are guaranteed against manufacturing faults for 24 months. However, the guarantee does **not** cover normal wear or damage caused by sharp-edged objects such as stones jammed in the tyres.

It has been designed to climb slopes up to 1:4 reliably and safely on reasonable surfaces. Always consider with care and consideration the action you are going to take by considering the effort required if you were attempting the manoeuvre using your tow car.

The Mover cannot overcome obstacles more than approx. 2.0 cm in height without assistance (please use wood wedges).

Due to the nature of a radio signal, it can get corrupted by external terrain or objects. So there may be small areas around the caravan where the quality of reception reduces, hence the Mover may stop momentarily.

Batteries

We recommend the use of so-called drive and lighting batteries. Gel batteries and round cell batteries are also suitable.

These batteries are designed for high power demands and have an extremely long service life. The maximum current consumption of the Mover is 120 A during full-load operation. The correct choice of battery depends on the usage period and the scope of use (other consumers in caravan). For mover operation we recommend batteries with a capacity of approx. 60 Ah or more.

Example:

A fully charged lead-acid battery with a capacity of 60 Ah allows the Mover to be operated for approximately 30 minutes (depending on weight of caravan, battery type and terrain).

The use of gel batteries or round cell batteries means that smaller batteries can be used.

Batteries with more capacity allow the equipment to be used for longer.

We recommend the use of chargers with the I_{u0} characteristic curve (e.g. Truma battery charger NT 12/ 3-18, Part no. 39901-01), which prevent the battery from being damaged because of overcharging, for example.

In the event of a fault, please contact your dealer or the Truma-Service (see page 9).

Before calling customer service, please check the following:

1. Are the batteries in the remote handset in good condition?
2. Is the caravan battery in good condition and fully charged?

Do not use the Mover if the battery voltage is below 10.2 V DC.

Changing the batteries in the remote handset

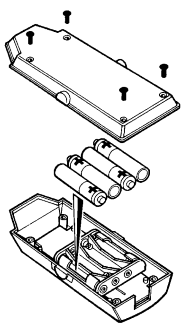

Please be sure to use leak proof micro-batteries only, type LR 03, AAA, AM 4, MN 2400 (1.5 V).

When fitting new batteries ensure the polarity is correct!



Dead and used batteries may leak and damage the remote handset. Remove the batteries if the handset is not going to be used for an extended period.

No claims under guarantee will be considered for damage caused by leaking batteries.

Before throwing away a defective handset, it is essential that the batteries are removed and disposed of in proper manner.

Aligning the electronic control unit and the remote handset

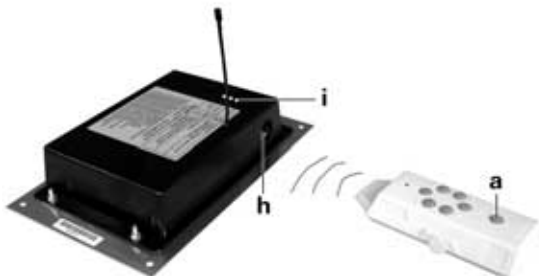

After replacing a electronic control unit or a remote handset the individuals must be aligned by the following procedure.

1. Ensure the Mover is installed in accordance with the installation instructions and the rollers are **disengaged**. Ensure the caravan battery is connected, in good condition and supplies 12 V, DC to the relay box.
2. Press reset button **(h)** on the relay box for approximately 5 seconds, and the green indicator lamp **(i)** will flash when the button is released.
3. Press the red button **(a)** on the handset twice within one second. This will align the handset and installed relay box.

1. Case of warranty

The manufacturer grants a warranty for malfunctions in the appliance which are based on material or production faults. In addition to this, the statutory warranty claims against the seller remain valid.

A claim under warranty shall not pertain:

- for parts subject to wear and in cases of natural wear and tear
- as a result of not original Truma parts being used in the appliance
- as a consequence of failure to respect the manufacturers instructions for installation and use
- as a consequence of improper handling
- as a consequence of improper transport packing.

2. Scope of warranty

The warranty is valid for malfunctions as stated under item 1, which occur within 24 months after conclusion of the purchase agreement between the seller and the final consumer. The manufacturers will make good such defects by subsequent fulfilment, i.e. at their discretion either by repair or replacement. In the event of manufacturers providing service under warranty, the term of the warranty shall not recommence anew with regard to the repaired or replaced parts; rather, the old warranty period shall continue to run. More extensive claims, in particular claims for compensatory damages by purchasers or third parties, shall be excluded. This does not affect the rules of the product liability law.

The manufacturer shall bear the cost of employing the Truma customer service for the removal of a malfunction under warranty – in particular transportation costs, travelling expenses, job and material costs, as long as the service is carried out by an authorised Truma-Dealer.

Additional costs based on complicated removal and installation conditions of the appliance (e.g. removal of furniture or parts of the vehicle body) do not come under warranty.

Rollers carry 24 months warranty against manufacturing defects. Rollers are, like the tyres on your caravan a consumable item and the grit will eventually wear down. Also, the grit can be damaged by sharp stones becoming embedded in your caravan tyre: take care to remove sharp stones from your tyres prior to using your Mover.

3. Raising the case of warranty

In the event of faults, in principle the Truma Service Centre is to be notified: Truma UK Ltd, Eastern Avenue, Burton upon Trent, Staffordshire, DE 13 0BB.

In other countries, respective service partners are available (refer to address list). Complaints must be specified. In addition, the correctly completed warranty certificate must be presented or the Serial number of the appliance and the date of purchase specified.

In order for the manufacturers to be able to determine whether an incident subject to warranty has occurred, the end user must, at his own risk, bring the device to the manufacturers or send it to them.

In instances of the device being sent to the works, dispatch is to be effected by freight transport. In cases under warranty, the works shall bear the transport costs or the costs of delivery and return. If the damage is deemed not to be a warranty case, the manufacturer shall notify the customer and shall specify repair costs which shall not be borne by the manufacturer; in this case, the customer shall also bear the shipping costs.

Installation instructions



Please fold out the page with diagrams!

Read the installation instructions prior to starting work and follow them carefully!

Intended use

The **Caravan Mover** (for caravans **without shock absorbers**) / **Euro Mover** (for caravans **with shock absorbers**) is designed for use with single-axle caravans with a total weight of up to 1700 kg.

Installation using the standard installation kit is only possible on caravans/trailers within the following dimensions.

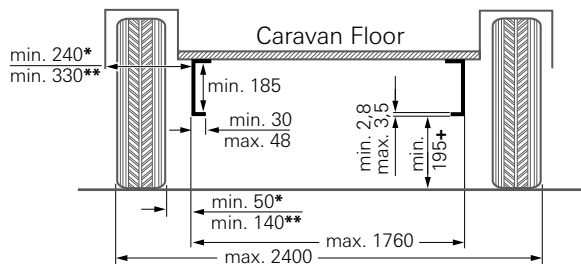

all dimensions in mm

* With shock absorbers fitted (Euro Mover)

**Without shock absorbers fitted (Caravan Mover)

+ With fully loaded vehicle



A distinction is made between L-profiled and U-profiled chassis as shown in the illustration.

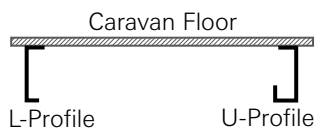

Measuring the chassis height

The chassis height (Y) is measured at point (X)

Euro Mover X = 140 mm

Caravan Mover X = 0 mm

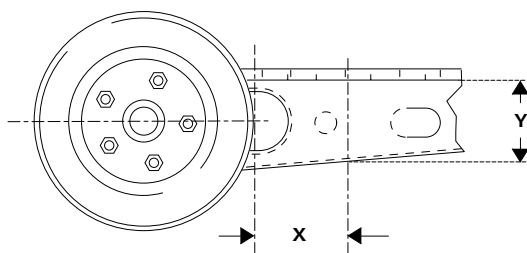

Determining the installation type

1. Standard installation

Standard installation is used with an L-profile chassis and a frame height (Y) of approx. 185 mm. **No special accessories** are required.

2. Installation on a chassis with U-profile

Standard installation is used with a U-profile chassis and a frame height (Y) of approx. 185 mm. A **U-profile chassis kit** is needed to compensate for the profile edge.

3. Installation on a chassis with L-profile and frame height of between 140 and 185 mm

With a chassis with a frame height (Y) of 140 mm to 185 mm, 1, 2 or 3 **spacer plate sets** and the **U-bolt extension kit** are needed to compensate for the height.

4. Installation on a chassis with U-profile and frame height of between 140 and 185 mm

The **U-profile chassis kit**, 1, 2 or 3 **spacer plate sets** and the **U-bolt extension kit** are required to compensate for the U-profile **chassis** edge and the height.

5. Installation on a chassis with L- and U-profiles with frame height of less than 140 mm

On a chassis with a frame height (Y) of less than 140 mm a **low chassis kit** must be fitted to compensate the height.



In Germany, the low chassis kit installation must be accepted by a vehicle expert.

6. The **AL-KO Vario III / AV installation kit** must be used with the AL-KO Vario III / AV chassis with a frame thickness of less than 2.8 mm.

Special accessory installation

1. U-bolt extension kit

(for **chassis** with L-profile, frame height **from 140 to 185 mm**)

U-bolts, nuts and washers, Part no. 60010-00100.

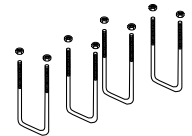

1.1. Spacer plate kit (two 15 mm spacer plates)

for height compensation max. 45 mm (3 plates) at each side (e.g. installed behind axle)

Part no. 60010-66000.

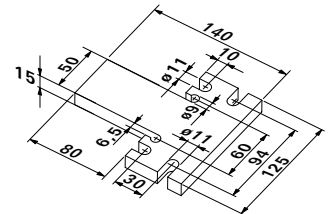

2. Low chassis kit

for height compensation for caravan/trailer with frame height of **less than 140 mm**,

Part no. 60010-64900.

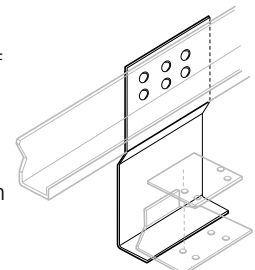

In Germany, this installation kit must be accepted by a vehicle expert.

3. U-profile chassis kit

(for chassis with U-profile, frame height **approx. 185 mm**)

U-bolt with clamping plates and self-locking nuts, stoppers, Part no. 60010-09200.

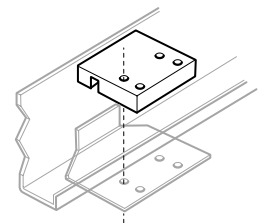

4. AL-KO Vario III / AV Installation kit

for caravans with AL-KO Vario III / AV Chassis (frame thickness less than 2.8 mm) **mandatory**, Part no. 60010-21500.

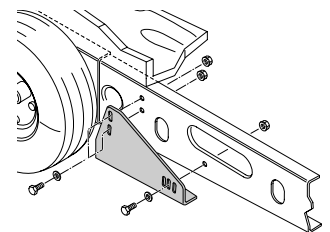

5. Cross actuation device

(for swivelling both drive units against the wheels from one side and releasing them again) connecting tube, middle tube, nuts, bolts, grub screws, Part no. 60010-18500.

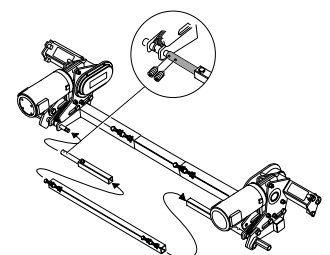

⚠ The Caravan Mover/Euro Mover is not approved for installation on caravans/trailers with any other chassis! Any drilling (exception: when using flat frame kit) or welding to the chassis is not allowed. Under no circumstances remove any suspension components from the chassis.

Approval

When installing the Mover always observe the technical and administrative rules and regulations of the country in which the vehicle is to be registered for the first time.

Any modification to the unit, or the use of spare parts and functionally-important accessories which are not original Truma components, or failure to respect the installation and operating instructions, will lead to the cancellation of the guarantee and to exclusion of claims for liability. In addition to this, the operational approval for the device will be cancelled.

For Germany, a general operating permit (ABE) has been issued. For export requirements please contact service.

Tools and facilities required

To install the unit you will need:

13 mm AF socket / wrench 13 mm AF combination spanner
Torque wrench (automotive size)
Cable cutter/Crimping tool
Power drill / screwdrivers / 25 mm hole cutter
Portable 2 tonne trolley jack and axle stands to suit
Appropriate lighting

Choice of location

We recommend to fit the Mover behind the rear axle. Under special circumstances (for example lack of space) the Mover can also be fitted in front of the front axle. Only the provided U-bolts must be used to attach the Mover (or the U-bolt extension special accessory).

The frame of the vehicle must be kept free of rust and heavy soiling and without any damages to the suspension components.

The caravan must be fitted with the same size and type of tyre on each wheel; to ensure the wheel diameter is identical, we recommend to install and set up the mover only with new tyres, these are to be inflated to manufacturer's specifications.

The Caravan Mover weighs approximately 30 kg, the Euro Mover weighs approximately 32 kg. Ensure the payload allowance of the caravan can accommodate this.

Installation of the drive units

i The AL-KO Vario III / AV installation kit (Part no. 60010-21500) must be used for caravans with the AL-KO Vario III / AV chassis (frame thickness less than 2.8 mm). For installation see instructions provided with installation kit.

- 1. Fig. A:** Remove all components from packing and place on the floor.
- Loosely screw all components together to form a cross strut. Nuts must be no more than finger-tight.
- 3. Fig. B:** Place the assembly loosely to the chassis with the exception of the stoppers (C – stoppers are attached when installation is complete).

i For chassis with U-profile frame, use U-profile chassis kit (Part no. 60010-09200) instead of clamping plates provided for standard installation. Fit the two clamping plates to the frame as shown in the illustration and attach using the U-bolts and nuts provided in the installation kit. (The provided stoppers replace the standard stoppers (C) and are attached when installation is complete).

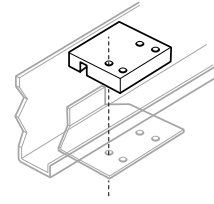

Position drive rollers such that they are in front of or behind the tyres at wheel hub height (middle of wheel). No height compensation is required for the standard installation (frame height approx. 185 mm).

With frame heights of 140 mm to 185 mm, use U-bolt extension kit (Part no. 60010-00100) and spacer plate set (Part no. 60010-65000) to set the drive rollers to the correct height (middle of wheel).

For height compensation (as shown in fig. B) clamp 1 to 3 spacer plates (d) between the cross strut and the vehicle frame (maximum of 3 plates). Use the extended U-bolts for installation.

For greater height differences, a low chassis kit (Part no. 60010-09400) is available from Truma as a special accessory – for installation see instructions provided with low chassis kit.

4. Fig. C: Create an adequate distance between the chain guard and the wheels/shock absorbers by moving the drive units to the side so that they do not come into contact with each other.

5. Fig. D: Move adjustable middle tube into a central position and tighten the 2 bolts at the side a little.

Create the correct distance between the tyre and the roller (20 mm) with the provided spacer by moving the drive units in the longitudinal direction.

6. Once the drive units have been correctly positioned, tighten the U-bolt nuts a little and then check that the distance between the rollers and the tyres is 20 mm. The weight of the caravan must be on the wheels when doing this. Check that there is adequate floor clearance.

7. Re-check the distance of 20 mm from the tyres (with weight on wheels) and then tighten the nuts on the U-bolts (20 Nm for W/F 13 mm), and the 4 bolts of the middle tube (15 Nm).

8. Fig. B: After installing in the correct position, fit stoppers (C) immediately in front of and behind the retaining plates. The stoppers prevent the Mover from sliding on the vehicle frame during operation.



When the rollers are applied the minimum distance for dimensions „a“ and „b“ is 10 mm (**fig. C**).

9. Once the Mover has been correctly fitted and secured, the one-sided operating facility that is available as a special accessory can be installed as described in the provided installation instructions.

Installation of motor cables and control unit

 Remove battery cable terminals and disconnect any external electrical power before starting work. If you are unsure about the electrical installation, have it checked out by a qualified Auto Electrician.

Pre-fitted, each motor has two heavy-duty cables (6 mm²). All the cables have to be routed along the underside of the caravan floor to the point where the electronic control unit will be situated. An example of a suitable location for the relay controller is in a bed stowage box in close proximity to the manoeuvring aid, **at least 40 cm away from the battery.**

 The battery connection cables may not be lengthened. The connecting cables to the motor and the battery must be separate and must not be routed via the relay box.

1. Fig. F: Attach relay controller (installed horizontally with antenna in a vertical position) to floor of stowage box with provided screws.

2. Drill a 25 mm hole, approximately 150 mm in front of control unit for the motor cables.

 Take care to avoid any chassis members, gas pipes and electrical wires! The connecting cables to the motor and the battery must not be routed parallel to each other.

3. Route motor connecting cable to relay controller along underbody of caravan and attach to chassis or underbody using the provided clips and screws. Take care to secure the cables so they will not chafe on the chassis or sag below the floor (use supplied protection tubing).

 **The motors move** when the drive rollers are engaged, **so allow a little slack** at the motors to avoid the **cables** being stretched.

4. Mark the relevant motor connecting cables and then **cut to length** accordingly (before or after the axle, depending on the installation). Crimp provided spade connectors to the cables (**fig. G**) and connect in accordance with wiring diagram (**fig. E**) (**red = positive, black = negative**).

 Excess cable must be cut to length and not looped inside the bedding locker. A good quality connection on each cable is essential!

5. Fig. E and F: Route battery connecting cables (10 mm²) to relay controller and securely attach using the provided clips and screws.

 Route battery connecting cables so that they do not chafe (particularly at leadthroughs through metal panels). Use water hoses or leadthrough grommets to prevent damage to cables. Connect battery connecting cables to the existing battery terminals (**red = positive, black = negative**).

6. Re-check whether all cables are correctly connected, attached using the provided clips and cannot chafe.

Commissioning the Mover

1. Ensure the battery used to operate the Mover is fully charged (do not operate the Mover if the voltage in the battery is below 10.2 V DC).

2. Place the caravan outside in a clear area and pull on the handbrake. Ensure that the rollers are disengaged from the road tyres and the corner steadies are raised.

3. Connect battery terminals to battery, check that all cables are secure and not hot or indicating signs of short circuits, etc.

4. Press the red button on the remote control twice within one second. This switches the remote control on and the LED illuminates. If LED does not illuminate, check polarity and condition of batteries in remote control. The remote control switches itself off after about 40 seconds if no buttons are pressed.

5. Check that both drive motors are stationary. With the handset switched on, and within 2 m of the control unit, press the forward button. Check that both drive motors are driven.

6. Press the red button again to switch off the handset and Mover.

7. Engage the drive rollers by use of the 19 mm AF wrench provided or the steady leg brace. The action will be quite stiff and will snap into place. The movement required is just over 1/2 turn. Turn the wrench until it will turn no more without excessive force. do this on both sides of the caravan.

8. Ensure that there no obstacles around the caravan, release the handbrake and switch the remote control on. Now check all functions several times according the operating instructions.

9. Press the red button again to switch the handset and Mover off. Release the drive mechanisms with the wheel brace (19 mm) and recheck the roller to tyre spacing. Adjust if necessary.

 The distance between the rollers and the tyres is 20 mm.

Warning information

The yellow sticker with the warning information, which is enclosed with the appliance, must be affixed by the installer or vehicle owner to a place in the vehicle where it is clearly visible to all users (e.g. on the wardrobe door)! Ask Truma to send you a sticker, if necessary.

Technical data

Designation:	Caravan Mover II Euro Mover II
Area of operation:	Single axle caravans with a total weight up to 1700 kg
Operational voltage:	12 V DC
Current consumption:	Average 30 A Maximum 120 A
Stand by consumption:	< 15 mA
Speed:	Approx. 22 cm per second (depending of the tyre size)
Maximum tyre width:	205 mm
Weights:	Caravan Mover II, approx. 30 kg Euro Mover II, approx. 32 kg



Right to effect technical modifications reserved!



R&TTE Declaration of Conformity (DoC)

We,

Truma Gerätetechnik GmbH & Co. KG

Wernher-von-Braun-Str. 12, D-85640 Putzbrunn, Germany,
(name and address of the manufacturer)

declare under our sole responsibility that the product:

product name: Euro Mover
trade name: Euro Mover II,
Euro Mover M1,
Caravan Mover II,
Twin Mover/Euro Mover Tandem
type or model: Euro Mover II,
Euro Mover M1, Caravan Mover II,
Twin Mover/Euro Mover Tandem

to which this declaration relates is in conformity with the essential requirements and other relevant requirements of the R&TTE Directive (1999/5/EC).

The product is compliant with the following standards and/or other normative documents:

SAFETY (art 3.1.a): EN 60950-1:2001
(title and/or number and date of issue of the standard(s) or other normative document(s))

EMC (art 3.1.b): EN 301489-3:2002,
(title and/or number and date of issue of the standard(s) or other normative document(s))

SPECTRUM (art 3.2): EN 300220-1:2000, EN300220-3:2000
(title and/or number and date of issue of the standard(s) or other normative document(s))

OTHER: 72/245/ECC, 95/54/EC
(title and/or number and date of issue of the standard(s) or other normative document(s))

Sales Countries: AT, BE, CH, CY, CZ, DE, DK,EE, ES, FI, FR, GB, GR, HU, IE, IS, IT, LT, LU, LV, MT, NL, NO, PL, PT, SE, SI, SK

Supplementary information: class 1, Frequency 433,92 MHz

Place and date of issue: Putzbrunn, 30.03.2005

Signed by or for the manufacturer:

(Signature of authorised person)

Name (in writing)

Dr. Gerd Fricke

Title:

CTO

- A** Holzer-Caravan Klagenfurt, Ehrentaler Straße 33, 9020 Klagenfurt, Tel./Fax 0043 (0)463 433 57, Mobil (0)664 140 61 40
- Bachner Wohnwagen & Reisemobile GmbH, Werner-Gröbl-Straße 3, 8501 Lieboch, Tel. 0043 (0)3136 625 25, Fax 0043 (0)3136 625 25 10
- Egger Camping-Service, Bachzeile 12, 8940 Liezen, Tel./Fax 0043 (0)664 401 51 83, Mobil (0)664 401 51 83
- Installationen Josef Buchner, Nr. 39, 5722 Niedernsill, Tel. 0043 (0)6548 82 62, Fax 0043 (0)6548 826 24, Mobil (0)664 161 93 69
- Wagner-Camping-Service, Frauenbachergasse 22, 2320 Rannersdorf, Tel. 0043 (0)1706 37 60, Mobil (0)664 253 41 54
- Brodinger & Tulipan, Camping-Technik-Putz, Landstraße 5, 5020 Salzburg, Tel. 0043 (0)662 87 67 48 12, Fax 0043 (0)662 87 67 22 10, Mobil (0)664 160 53 01
- Messer Austria GmbH, Austr. 2, 6832 Sulz, Tel. 0043 (0)5522 44 43 53, Fax 0043 (0)5522 44 43 33, Mobil (0)664 264 40 05
- AUS** Dometic Pty Ltd, 6 Treforest Drive, Clayton, Vic. 3168, Tel. 0061 (0)3 95 45 56 55, Fax 0061 (0)3 95 45 59 66
- B** Gautzsch Gimeg N.V., Drie Sleutelsstraat 74, 9300 Aalst, Tel. 0032 (0)53 70 66 77, Fax 0032 (0)53 21 61 62
- BY** Tachograph Ltd., P. Brovki Str. 15, 220072 Minsk, Tel. 00375 (0)17 22 66 82 02, Fax 00375 (0)172 89 25 52
- CH** Selzam AG, Harzachstrasse 8, 8404 Winterthur, Tel. 0041 (0)52 233 25 21, Fax 0041 (0)52 232 97 15
- CZ** KOV, Karosárna a slévárna, Sokolovská 615, 28101 Velim, Tel. 00420 (0)321 76 35 58, Fax 00420 (0)321 76 33 37
- D** Truma Truma Gerätetechnik GmbH & Co. KG, Postfach 1252 D-85637 Putzbrunn, Telefon +49 (0)89 4617-2142, Telefax +49 (0)89 4617-2159
- DK** Olympic A/S, Tvaervej 2, 6640 Lunderskov, Tel. 0045 75 58 57 00, Fax 0045 75 58 63 07
- E** Stimme, S.L., Poligono Industr. Mediterraneo, Calle Ildefonso Carrascosa 2, 46560 Massalfassar (Valencia), Tel. 0034 961 40 00 58, Fax 0034 961 40 24 62
- EST** Parkli HL, Mustjõe 39, 10617 Tallinn, Tel. 00372 655 00 00, Fax 00372 656 26 30
- F** Euro Accessoires, ZAE Parc de Champagne – B.P. 89, 07303 Tournon-sur-Rhône Cédex, Tel. 0033 (0)4 75 06 92 92, Fax 0033 (0)4 75 06 92 96
- FIN** Kehä Caravan Tukku Oy, Koskelontie 15, 02920 Espoo, Tel. 00358 (0)9 84 94 30 34, Fax 00358 (0)9 84 94 30 30
- GR** G. Bournas - G. Efthimiou O.E., P. Ralli 36 & Ag. Annis, 12241 Egaleo - Athen, Tel. 0030 (0)210 346 14 14, Fax 0030 (0)210 342 34 03
- H** Virág Trans Bt., újhegyi út 7, 1108 Budapest, Tel. 0036 (0)1 433 57 61, Fax 0036 (0)1 261 32 49
- HR** Klimamobil, Štefanovečki zavoj 17a, 10040 Zagreb, Tel. 00385 (0)1 291 01 43, Fax 00385 (0)1 295 05 21
- I** Dimatec S.p.A., Via Galileo Galilei, 7, 22070 Guanzate (CO), Tel. 0039 031 352 90 61, Fax 0039 031 352 96 89
- IS** Afl-Húsbílar ehf., Gránufélagsgata 49, 600 Akureyri, Tel. 00354 462 79 50, Fax 00354 461 26 80
- Bilaraf Ltd., Audbrekka 20, 200 Kópavogur, Tel. 00354 564 04 00, Fax 00354 564 04 04
- J** Carac Industry Co., Ltd., 1-4-2 Heiwadai, Nerimaku, Tokyo 179-0083, Tel. 0081 (0)3 3931 02 20, Fax 0081 (0)3 3931 07 06
- L** Ets Geiben s.à.r.l., 260, route d'Esch, 4451 Belvaux, Tel. 00352 59 15 19, Fax 00352 59 44 55
- LT** Autokurtas, Lazdiju Str. 20, 3018 Kaunas, Tel. 00370 37 39 10 90, Fax 00370 37 39 14 54
- N** Neptus A.S., Høymyrmarka 7, 1391 Vollen, Tel. 0047 66 75 99 50, Fax 0047 66 75 99 51
- NL** Gautzsch Gimeg B.V., Strijkviertel 25, 3454 PH De Meern, Tel. 0900 373 73 73, Fax 0031 (0)30 666 53 97
- NZ** Leisure Appliances New Zealand Ltd, 34 Tauhinu Road, Miramar, Wellington, Tel. 0064 (0)4 380 93 92, Fax 0064 (0)4 380 93 98, Free Fax 0800 695 347
- P** J.C.L. Andrade, Lda., Apartado 718, Lugar do Padrao, E.N. 327 - S. Miguel do Souto, Sta. Maria da Feira, 4524-906 Souto V.F.R., Tel. 00351 256 80 10 34, Fax 00351 256 80 14 88
- Marcampo - Artigos de Campismo, Lda., Av. Almirante Gago Coutinho, 56D, 1700-031 Lissabon, Tel. 00351 21 848 67 76, Fax 00351 21 847 06 99
- PL** Truma Polska Sp. z o.o., ul. Kuczkowskiego 3/2U, 31-619 Krakau, Tel. 0048 (0)12 641 02 41, Fax 0048 (0)12 641 91 33
- RUS** Comapnija Poliauto, Hawskaja str. 3, ab 3., 113162 Moskau, Tel. 007 (0)95 232 00 29, Fax 007 095 958 27 57
- S** Alde International Systems AB, Wrangels Allé 90, 29111 Färlöv, Kristianstad, Tel. 0046 (0)44 712 74, Fax 0046 (0)44 718 48
- SLO** Prebil d.o.o., Opekarska 14, 1000 Ljubljana, Tel. 0038 (0)61 542 63 70, Fax 0038 (0)61 542 63 71
- SK** Tamex spol. s r.o., Kováčsova č. 359, 85110 Bratislava, Tel. 00421 (0)2 44 45 49 20, Fax 00421 (0)2 44 45 49 35
- TR** Karyat Karavan Yat San. Tic. Ltd. Sti., Kustili Cad. Efes Ishani Kat: 3, No: 171 Kadiköy, 81310 Istanbul, Tel. 0090 (0)216 418 73 96, Fax 0090 (0)216 418 73 97



Quality with tradition

Truma was founded in 1949. This middle-sized family concern is today Europe's leading manufacturer of gas heating systems for motor vehicles.

Truma develops, manufactures, and markets comfort equipment for caravans, motor homes, and boats

- Liquid gas heating systems
- Hot-air systems
- Air-conditioning systems
- Hot-water production systems
- Gas lights
- Convenience accessories for gas systems
- Manoeuvring aid for caravans

and supplementary heating systems for commercial vehicles.

The Truma Group also includes the company of ALDE, a Swedish manufacturer of hot water heating systems, and MPV-TRUMA, a firm which supplies technical medical products.



Reg. Nr. 17 505



Warranty Card
Garantie-Karte
Bon de Garantie
Certificato di Garanzia
Garantiebon
Garantikort
Tarjeta de garantía



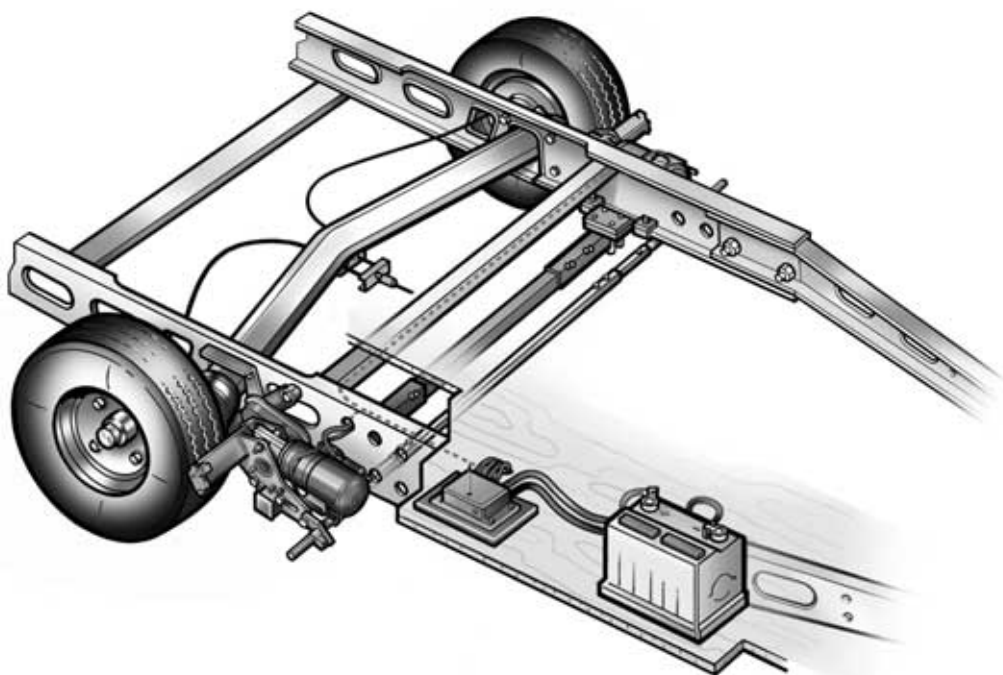

To be filled in by the dealer
Vom Händler auszufüllen
A remplir par le commerçant
Da far compilare dal rivenditore

Door de dealer in te vullen.
Udfyldes af forhandleren.
A ser rellendada por el comerciante.



Warranty Card
Garantie-Karte
Bon de Garantie
Certificato di Garanzia
Garantiebon
Garantikort
Tarjeta de garantía

- Caravan Mover
 Euro Mover

Caravan Mover Euro Mover

Serial number
Fabrik-Nummer
No. de fabrication
No. di matricola
Serie-nummer
Seriennummer
Número de fábrica

--	--	--	--	--	--	--	--	--	--	--	--	--	--	--	--	--	--	--	--	--

Date of sale
Verkaufsdatum
Date de vente
Data di vendita
Verkoopdatum
Salgsdato
Fecha de venta

Dealer's address
Händler-Adresse
Adresse du commerçant
Timbro del rivenditore
Dealeradres
Forhandleradresse
Dirección del comerciante